

KNIFE GATES

Pneumatic

BSM Knife gates are manufactured in four basic forms - '**Hand operated**', '**Chain operated**', '**Pneumatic**' and '**Motorised**'. The design and manufacture is done using the latest technology including CAD and laser profiling. The result is consistently high quality, ease of maintenance and spare part replacement. Laser profiling results in a light but robust knife gate. The inlet ports are generously sized with a protective cover shroud insert. This shroud ensures that contact of material with the sealing strips above the gate blade is minimised reducing wear and maintenance. The outlet port opening is larger than the inlet ensuring minimal chances of material hangup.

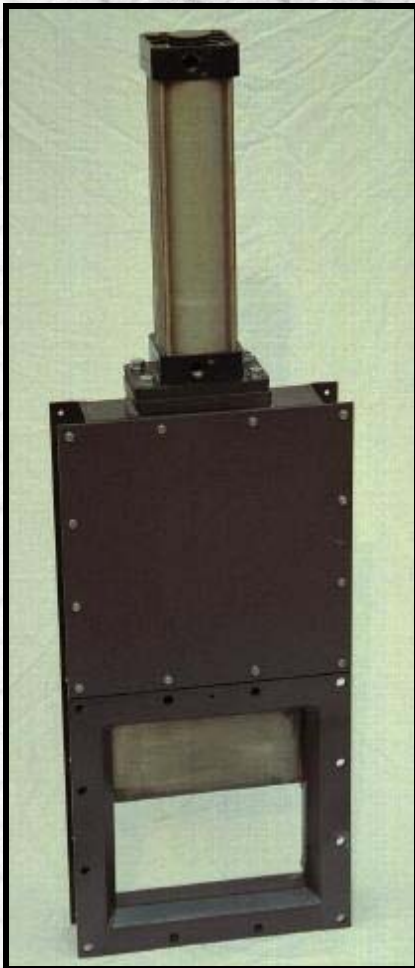

The design of the stuffing box is such that the packing can be changed with the knife gate blade in position and only the cover plate removed for access. The '**Hand operated**' valve uses a conventional hand wheel while the '**Chain operated**' version is ideal for hand operation where the gate is at an elevated position. The '**Pneumatic**' version is available for applications where the gate is difficult to reach or where control via an external control system is called for. Limit or proximity switches can be fitted as optional extras. For specialised applications a '**Motorised**' version is also available. Knife gates can also be supplied in stainless steel.

The design of the stuffing box is such that the packing can be changed with the knife gate blade in position and only the cover plate removed for access.

The '**Hand operated**' valve uses a conventional hand wheel while the '**Chain operated**' version is ideal for hand operation where the gate is at an elevated position. The '**Pneumatic**' version is available for applications where the gate is difficult to reach or where control via an external control system is called for. Limit or proximity switches can be fitted as optional extras. For specialised applications a '**Motorised**' version is also available. Knife gates can also be supplied in stainless steel.

Standard Sizes include: 150mm, 200mm, 250mm, 300mm, 350mm, 400mm and 500mm.
Other sizes manufactured on request.

Quality and Service !

Now you have a choice...

Tel : +27 (0)11-793-6267
Fax: +27 (0)11-793-6273
Unit A5 Sanlam Ind. Park
Masjien Street
Strijdom Park
PO Box 6385
Cresta 2118, South Africa
e-mail: sales@bulkmatic.co.za

BSM

Bulkmatic Solids Machinery(Pty)Ltd

www.bulkmatic.co.za



KNIFE GATE DATA SHEET

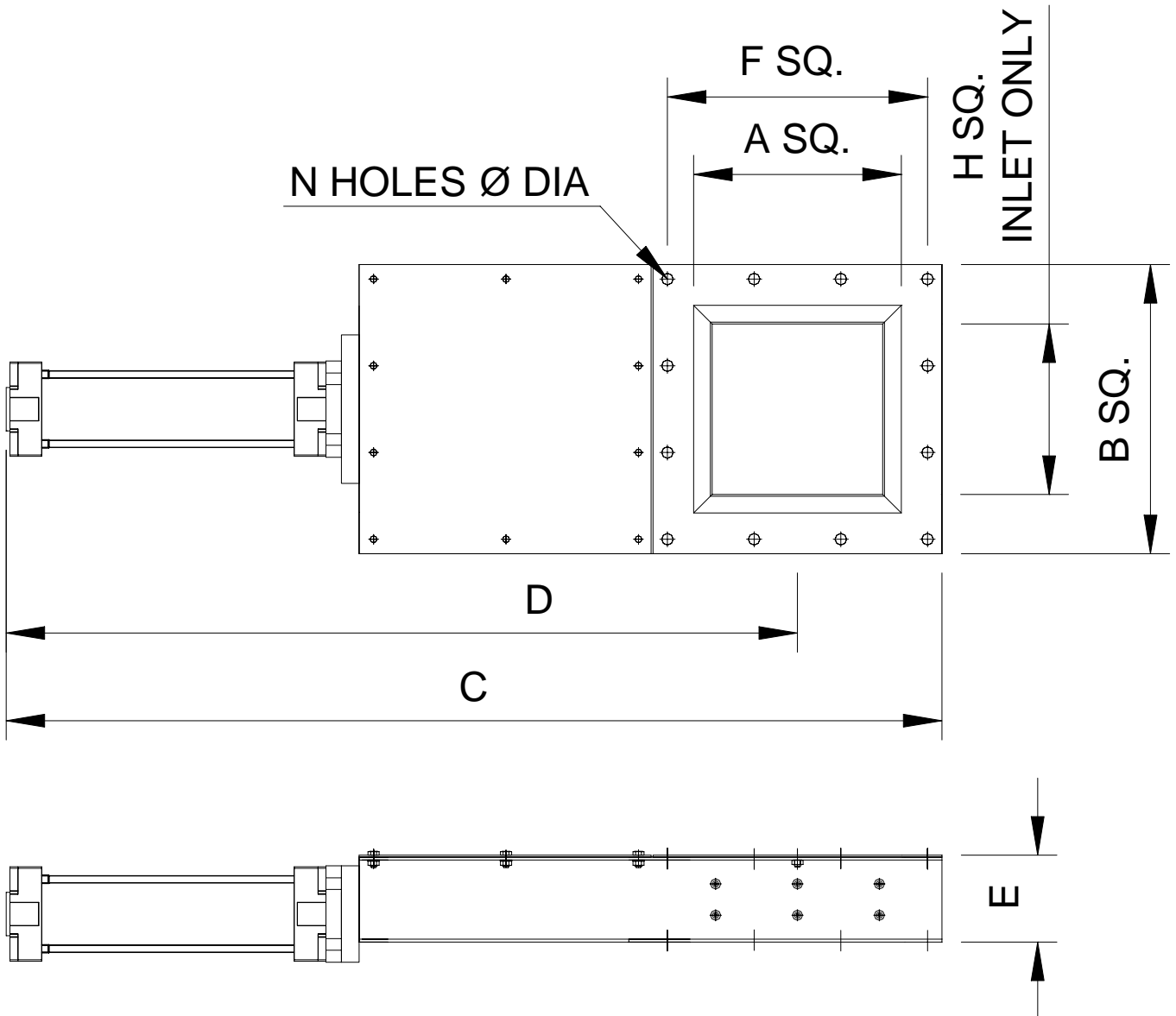

NOW YOU HAVE A CHOICE...

MADE IN SOUTH AFRICA

KNIFE GATES - PNEUMATIC CYLINDER OPERATED

UNIT NO.	A	B	C	D	E	F	N	H	DIA	WEIGHT kg
KG-0150-P	165	250	815	690	100	2x105=210	8	125	10	30
KG-0200-P	215	300	970	825	100	3x90=270	12	175	12	40
KG-0250-P	270	355	1125	950	100	3x105=315	12	230	12	50
KG-0300-P	315	405	1280	1080	100	3x125=375	12	280	14	55
KG-0350-P	355	440	1400	1180	100	3x135=405	12	320	14	75
KG-0400-P	400	510	1615	1390	110	3x155=465	12	365	14	100
KG-0500-P	500	610	1910	1605	110	4x142=568	16	465	14	120

BSM (Pty) Ltd Tel: +27 (0)11-793-6267 Fax: +27 (0)11-793-6273 P.O.Box 6385, Cresta 2118, South Africa e-mail: sales@bulkmatic.co.za

Manufacturers of Quality Machinery for Powder & Bulk Solids Handling

1.3/06.05/030.2

KNIFE GATES

Hand Operated

BSM Knife gates are manufactured in four basic forms - '**Hand operated**', '**Chain operated**', '**Pneumatic**' and '**Motorised**'. The design and manufacture is done using the latest technology including CAD and laser profiling. The result is consistently high quality, ease of maintenance and spare part replacement. Laser profiling results in a light but robust knife gate. The inlet ports are generously sized with a protective cover shroud insert. This shroud ensures that contact of material with the sealing strips above the gate blade is minimised reducing wear and maintenance. The outlet port opening is larger than the inlet ensuring minimal chances of material hangup.

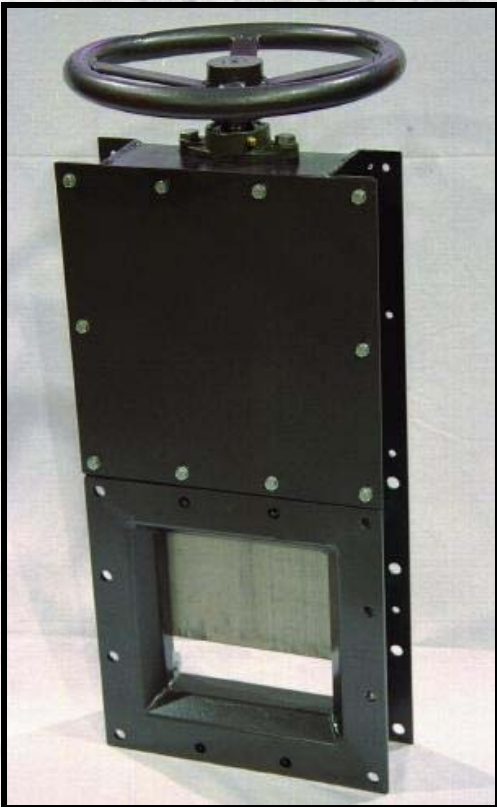

The design of the stuffing box is such that the packing can be changed with the knife gate blade in position and only the cover plate removed for access.

The '**Hand operated**' valve uses a conventional hand wheel while the '**Chain operated**' version is ideal for hand operation where the gate is at an elevated position. The '**Pneumatic**' version is available for applications where the gate is difficult to reach or where control via an external control system is called for. Limit or proximity switches can be fitted as optional extras. For specialised applications a '**Motorised**' version is also available. Knife gates can also be supplied in stainless steel.

Standard Sizes include: 150mm, 200mm, 250mm, 300mm, 350mm, 400mm and 500mm.
Other sizes manufactured on request.

Quality and Service !

Now you have a choice.....

Tel : +27 (0)11-793-6267
Fax: +27 (0)11-793-6273
Unit A5 Sanlam Ind. Park
Masjien Street
Strijdom Park
PO Box 6385
Cresta 2118, South Africa
e-mail: sales@bulkmatic.co.za

BSM

Bulkmatic Solids Machinery(Pty)Ltd

www.bulkmatic.co.za



KNIFE GATE DATA SHEET

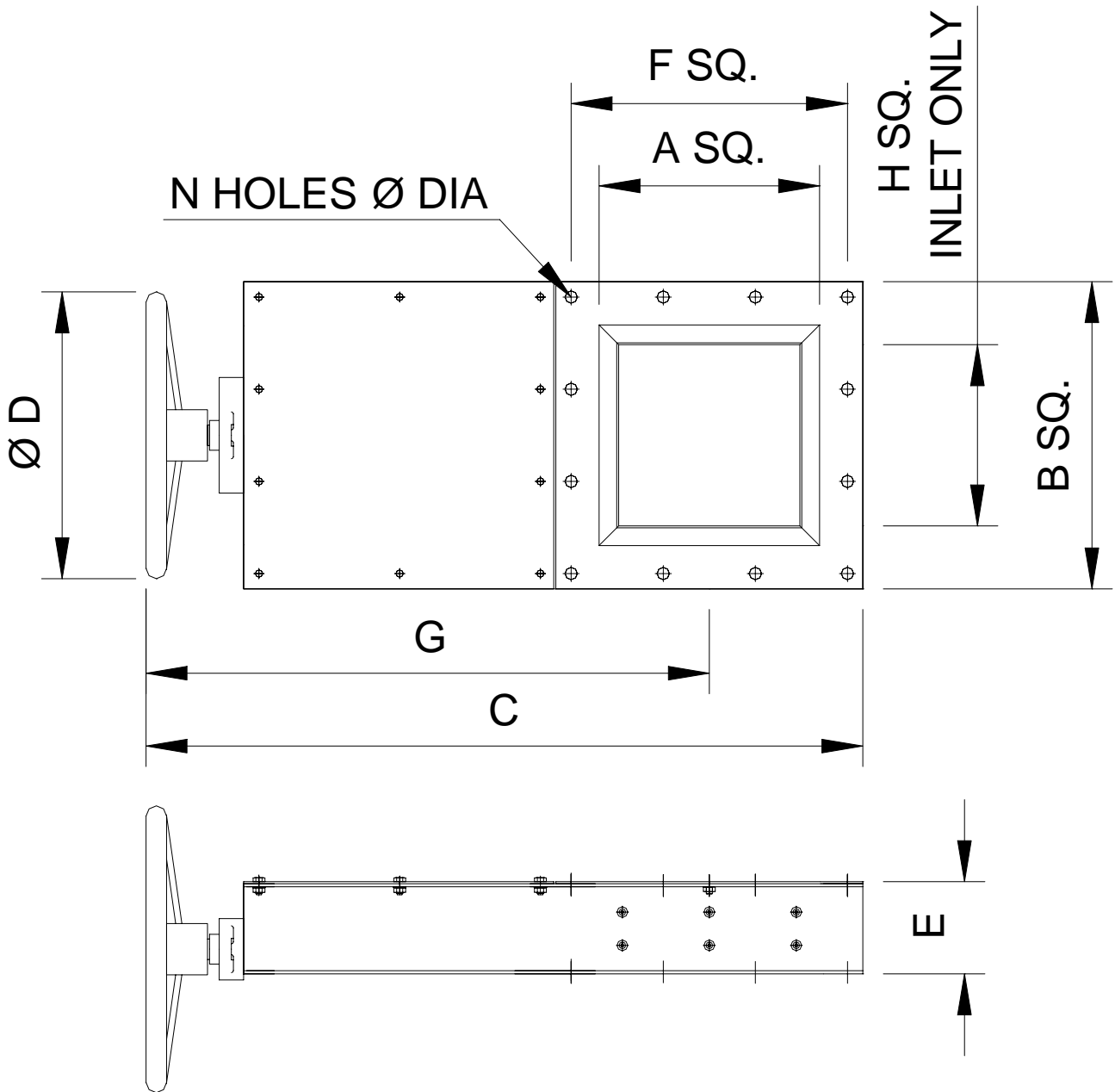

NOW YOU HAVE A CHOICE...

MADE IN SOUTH AFRICA

KNIFE GATES - HAND OPERATED

UNIT NO.	A	B	C	D	E	F	G	N	H	DIA	WEIGHT kg
KG-0150-H	165	250	620	300	100	2x105=210	495	8	125	10	16
KG-0200-H	215	300	720	300	100	3x90=270	570	12	175	12	20
KG-0250-H	270	355	830	300	100	3x105=315	655	12	230	12	25
KG-0300-H	315	405	935	300	100	3x125=375	735	12	280	14	35
KG-0350-H	355	440	1005	300	100	3x135=405	785	12	320	14	40
KG-0400-H	400	510	1145	300	110	3x155=465	890	12	365	14	45
KG-0500-H	500	610	1345	300	110	4x142=568	1040	16	465	14	55

BSM (Pty) Ltd Tel: +27 (0)11-793-6267 Fax: +27 (0)11-793-6273 P.O.Box 6385, Cresta 2118, South Africa. e-mail: sales@bulkmatic.co.za

Manufacturers of Quality Machinery for Powder & Bulk Solids Handling

1.3/06.05/030.1